



## Whiffen Walk

East Malling, West Malling ME19 6TZ

- CHAIN FREE!!
- Driveway And Garage
- Popular 'Bradbourne Fields' Development
- Master Bedroom With En-Suite
- Downstairs W/C
- Ready To View Now

**Asking Price £525,000 Freehold**

Local Authority  
Council Tax Band E  
EPC Rating C

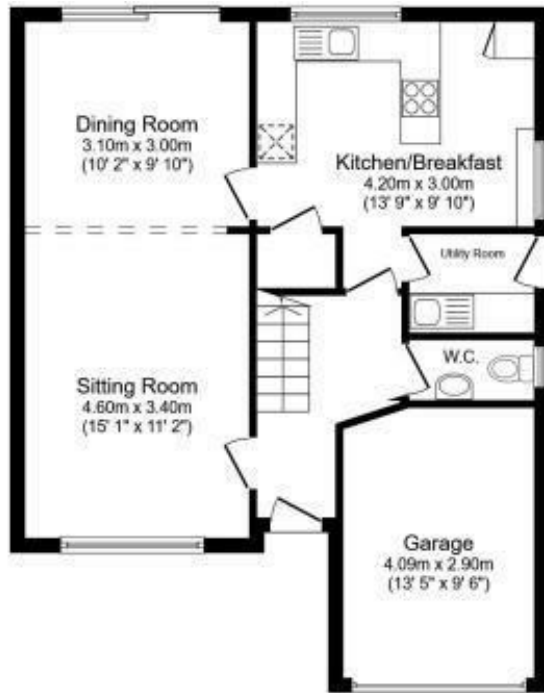

Ground Floor



First Floor

Total floor area 123.4 sq.m. (1,328 sq.ft.) approx.

This floor plan is for illustrative purposes only. It is not drawn to scale. Any measurements, floor areas (including any total floor area), openings and orientation are approximate. No details are guaranteed, they cannot be relied upon for any purpose and they do not form part of any agreement. No liability is taken for any error, omission or misstatement. A party must rely upon its own inspection(s). Plan produced for Your Move, Powered by [www.localagent.com](http://www.localagent.com).

#### Malling Office

777 London Road, Larkfield, Aylesford,  
Kent, ME20 6DE

#### Contact

01732 875706  
[larkfieldsales@simonmiller.co.uk](mailto:larkfieldsales@simonmiller.co.uk)  
<https://simonmiller.co.uk/>

Agents Note: Whilst every care has been taken to prepare these particulars, they are for guidance purposes only. All measurements are approximate and for general guidance purposes only and whilst every care has been taken to ensure accuracy, they should not be relied upon and potential buyers/tenants are advised to recheck the measurements.

